

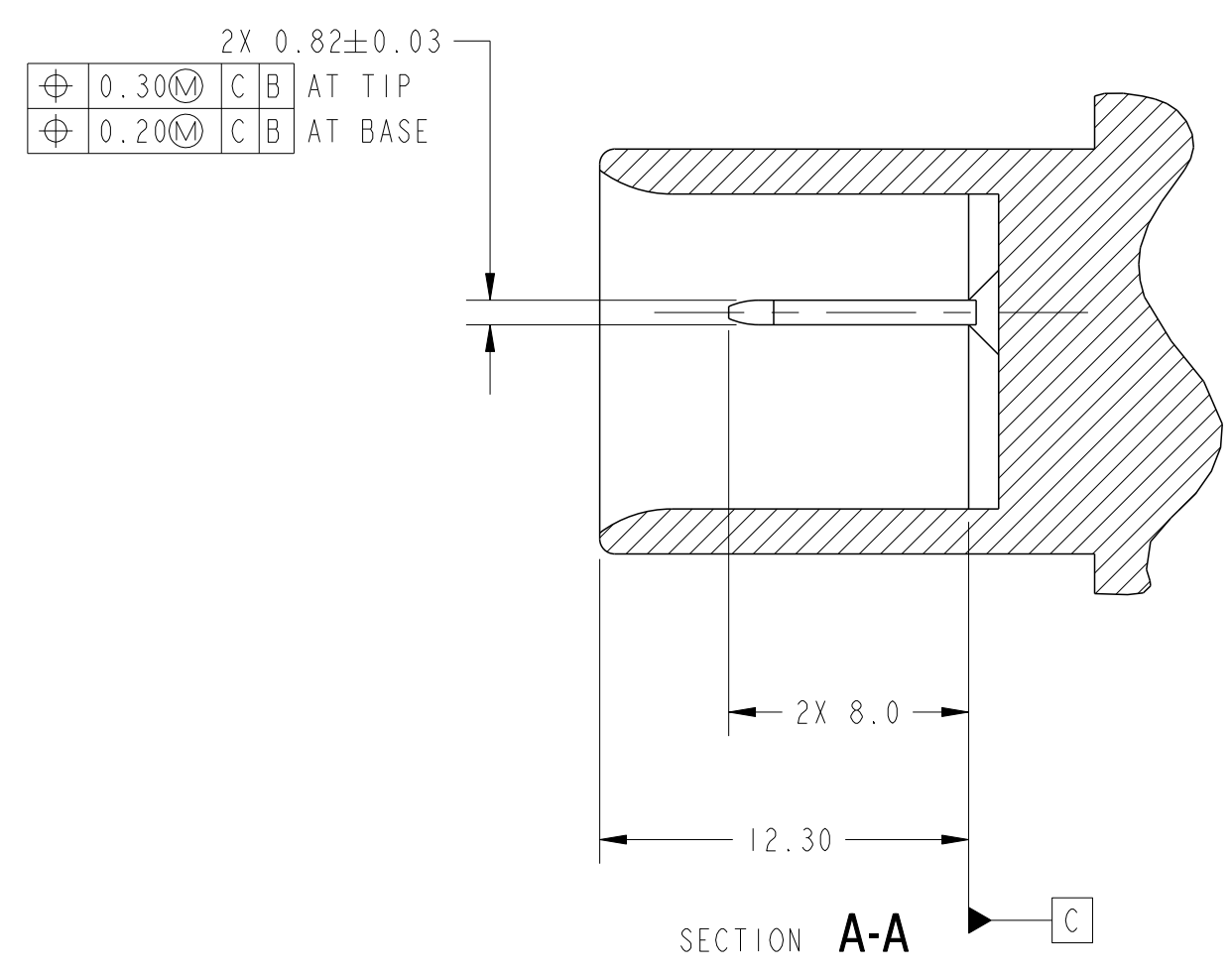

APPLICABLE HEADER SPECIFICATION FOR ASSEMBLY  
XR3T-14A464-AA

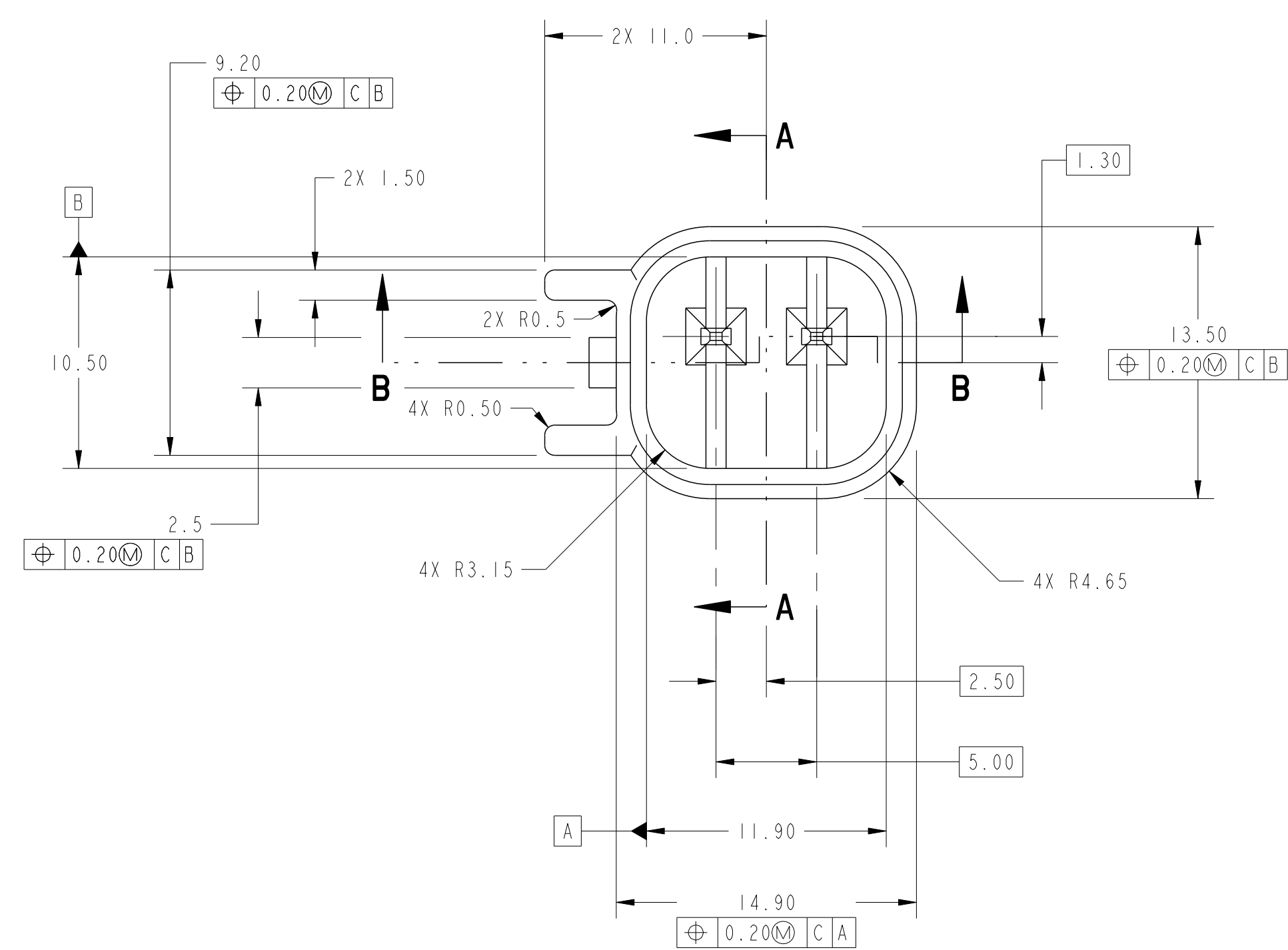

NOTES: UNLESS OTHERWISE SPECIFIED  
GENERAL TOLERANCES  
 $\pm 0.3$  ALL ONE PLACE DIMENSIONS  
 $\pm 0.10$  ALL TWO PLACE DIMENSIONS  
 $\pm 1.00^\circ$  ALL ANGULAR DIMENSIONS  
DRAFT ANGLE PERMISSIBLE ONLY WITHIN DRAWING TOL.  
 $0^\circ 30'$  MAXIMUM DRAFT ANGLE PER SIDE  
ALL UNSPECIFIED RADII 0.5  
WHEN A TIN / GOLD TERMINAL IS USED ON  
THE WIRING SIDE THEN CORRESPONDING PLATING  
(i.e. TIN OR GOLD) MUST BE USED ON THE HEADER  
PLATING ACCORDING TO SPEC NUMBERS:  
ES-F80B-14A229-AA, BA, CA, DA

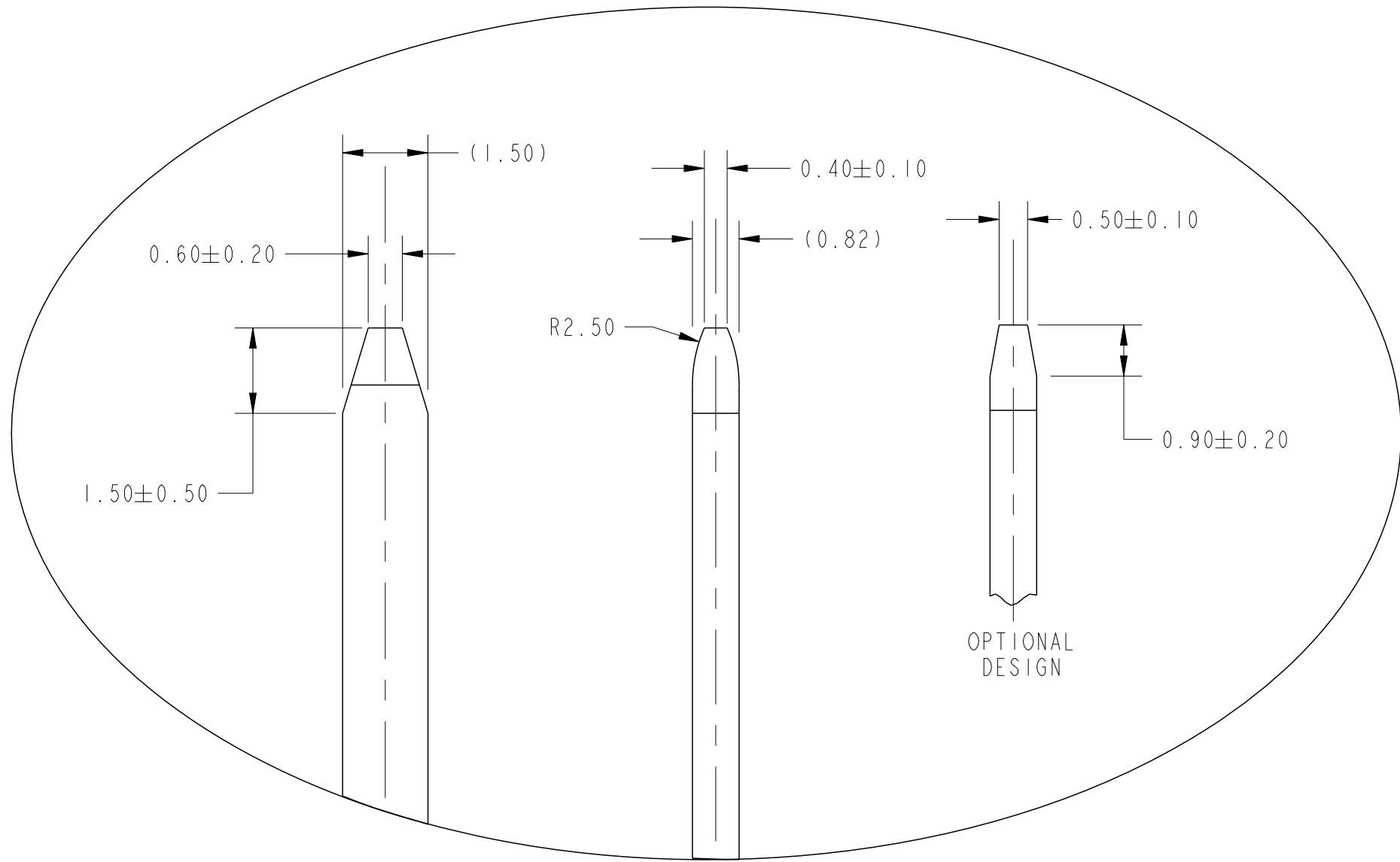
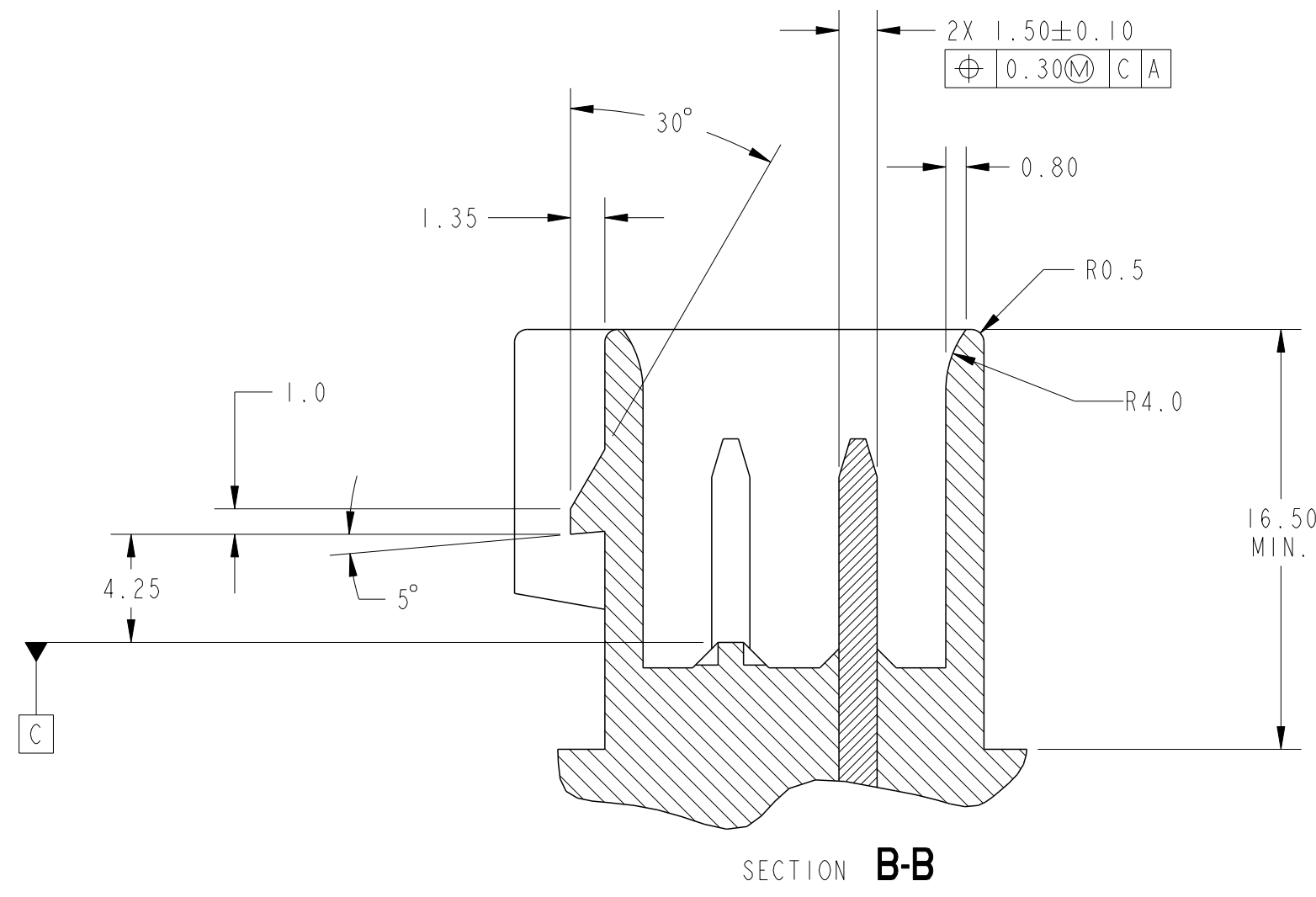

TERMINAL BLADE DETAIL  
MATERIAL: C510 PHOS. BRONZE (3/4 HARD)  
FINISH 0.003  $\pm 0.001$  TIN PLATING  
SCALE: 10:1



DRAWING	LU5T-14A464-ALA	REV	SHT	2
CAD FILE		REL	OF	2
FORD MOTOR COMPANY				