

APPLICABLE COMPONENTS						
ITEM	DESCRIPTION	MANDATORY (YES/NO)	TERMINAL CAVITY MIN/MAX OD	PLATING/MATERIAL	FORD COMPONENT PART NO.	SUPPLIER COMPONENT PART NO.
1	TRC B982/ 1.2mm (APPLICABLE CAVITIES 1-6)	NO	0/2.08X2.57	REFERENCE TRC	N/A	N/A

CONNECTOR ASSEMBLY CHART						
ASSEMBLY PART NO.'S						MATING COMPONENT
FORD COMPONENT PART NO.	SUPPLIER COMPONENT PART NO.	TEMP CLASS	VIBRATION CLASS	SEALING CLASS	BRANDING & CODING	FORD COMPONENT PART NO.
MUST-14A459-TA	6098-8622	T2	V1	S1	N/A	JU5T-14489-BSC
MUST-14A459-UA	6098-8623	T2	V1	S1	N/A	MUST-14489-BJA
N/A	N/A	T2	V1	S1	N/A	N/A
N/A	N/A	T2	V1	S1	N/A	N/A

ITEM	P/A DESCRIPTION	COLOR	FORD COMPONENT PART NO.	SUPPLIER COMPONENT PART NO.	MATERIAL/SPEC NO.	RECYCLING CODE	WEIGHT	MM DIMS REQD			
1	MALE HOUSING KEY A	BLACK	N/A	6098-7694	PBT/WSS-M99P23-B	PBT	3.10g	1			
1	MALE HOUSING KEY B	GRAY	N/A	6098-7696	PBT/WSS-M99P23-B	PBT	3.10g	1			
1	MALE HOUSING KEY C	BROWN	N/A	6098-7698	PBT/WSS-M99P23-B	PBT	3.10g		1		
1	MALE HOUSING KEY D	GREEN	N/A	6098-7700	PBT/WSS-M99P23-B	PBT	3.10g			1	
2	TPA	NATURAL	N/A	6910-7361	PBT/WSS-M99P23-B	PBT	0.13g	1	1	1	1

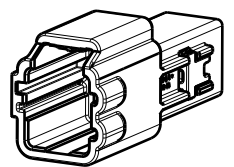

ISOMETRIC VIEW
SCALE 1:1

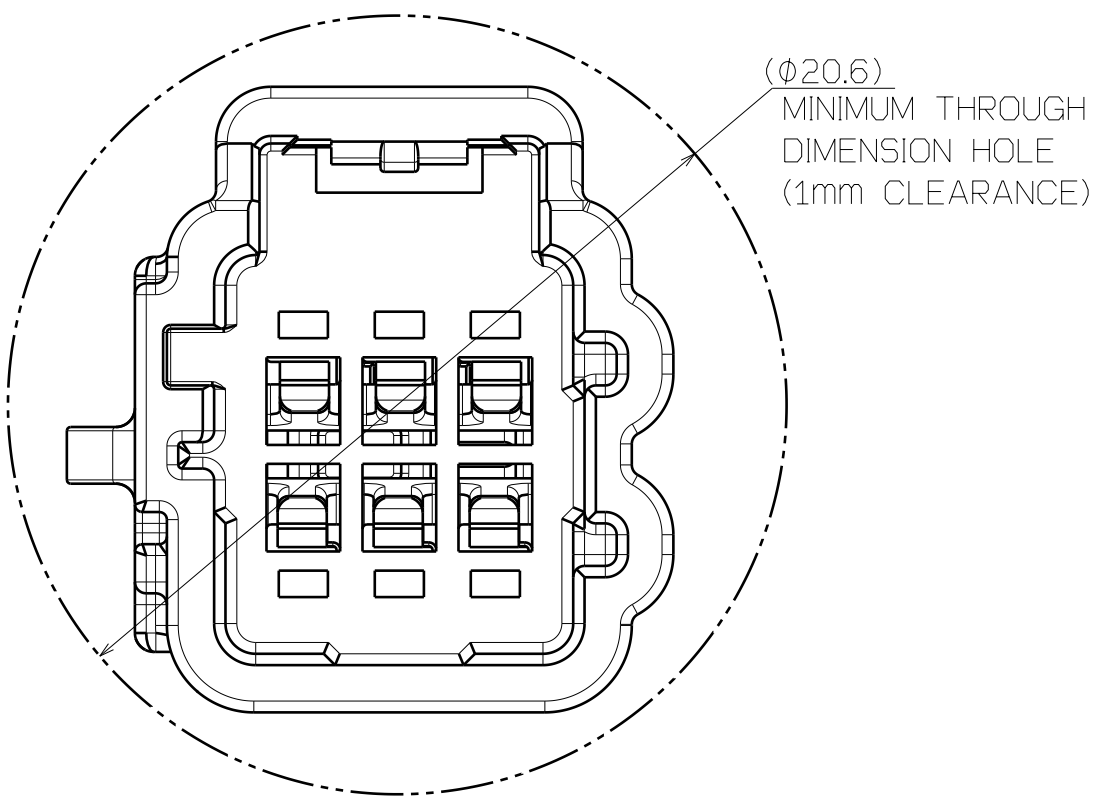

(Ø20.6)
MINIMUM THROUGH
DIMENSION HOLE
(1mm CLEARANCE)

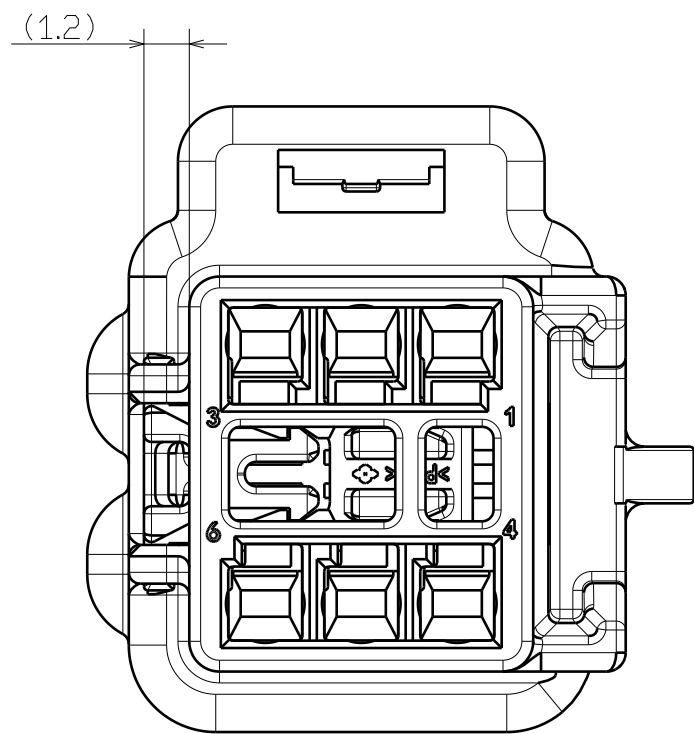

TPA IN PRE-SET POSITION

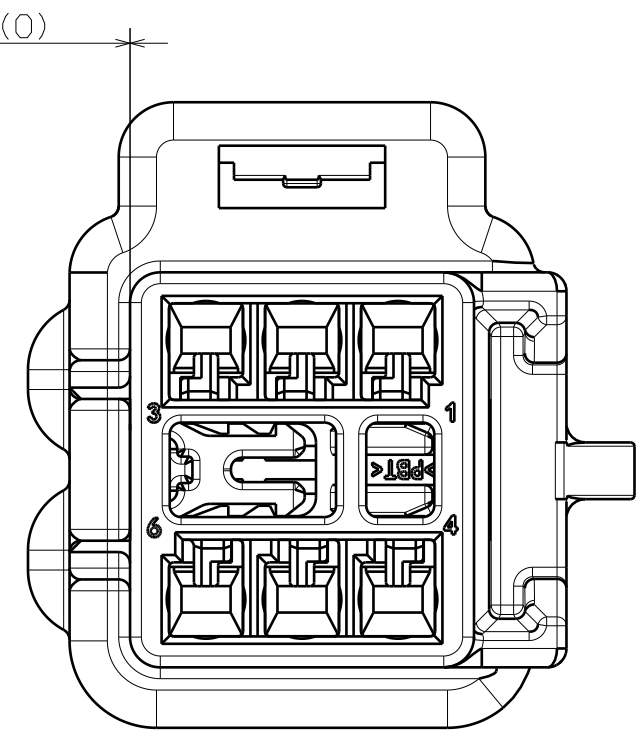

TPA IN LOCKED POSITION

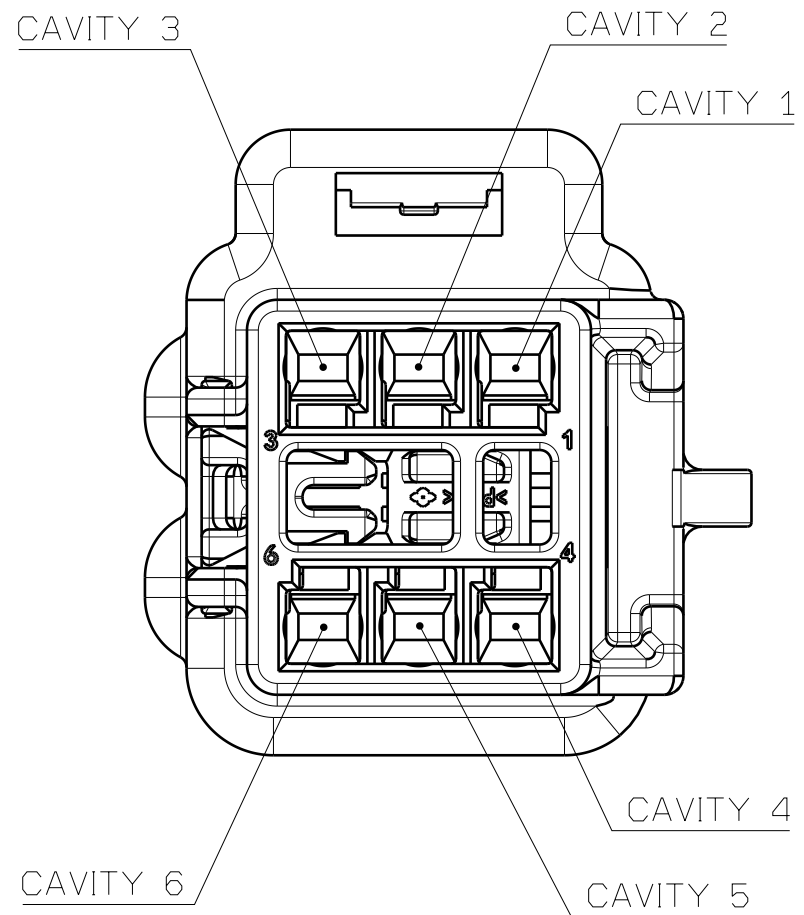
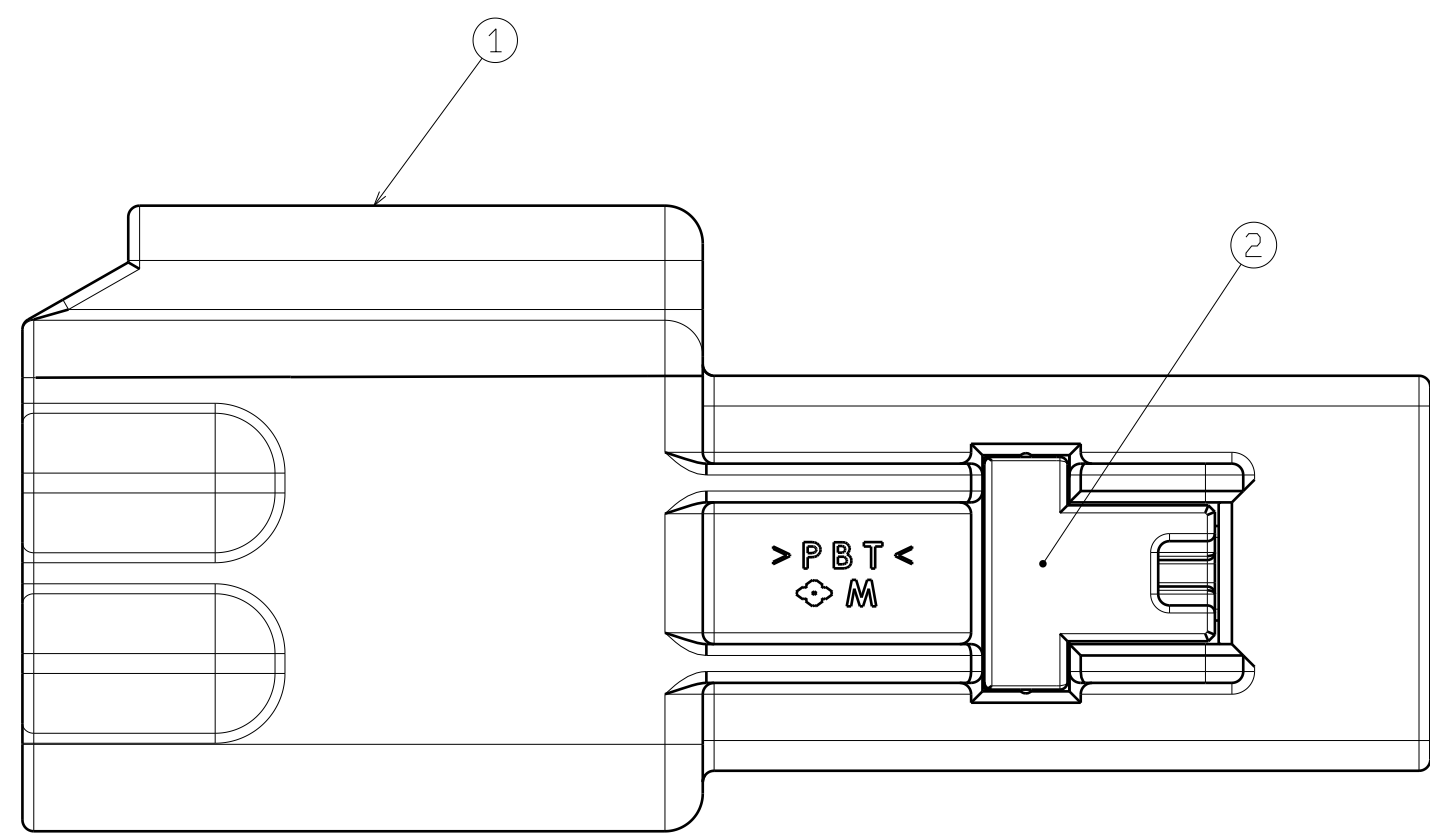
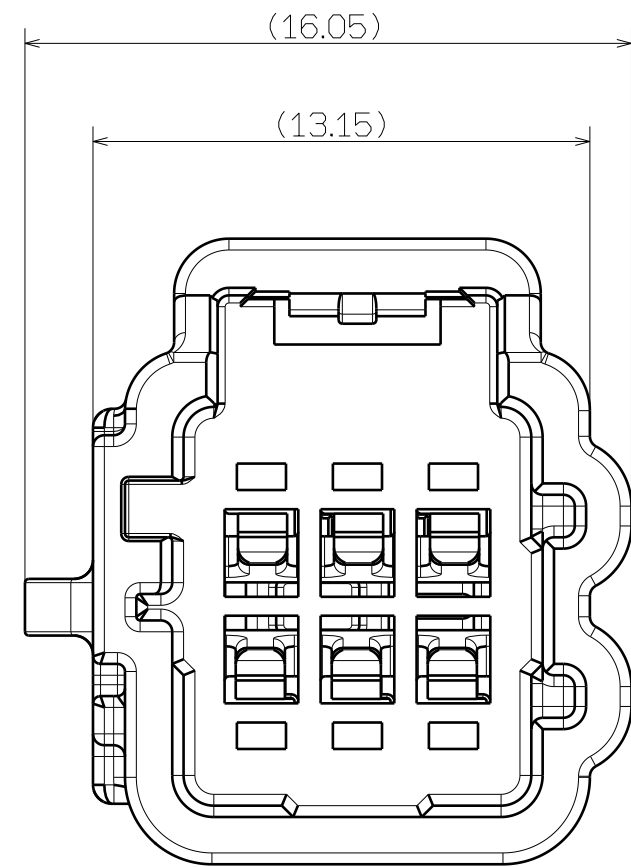
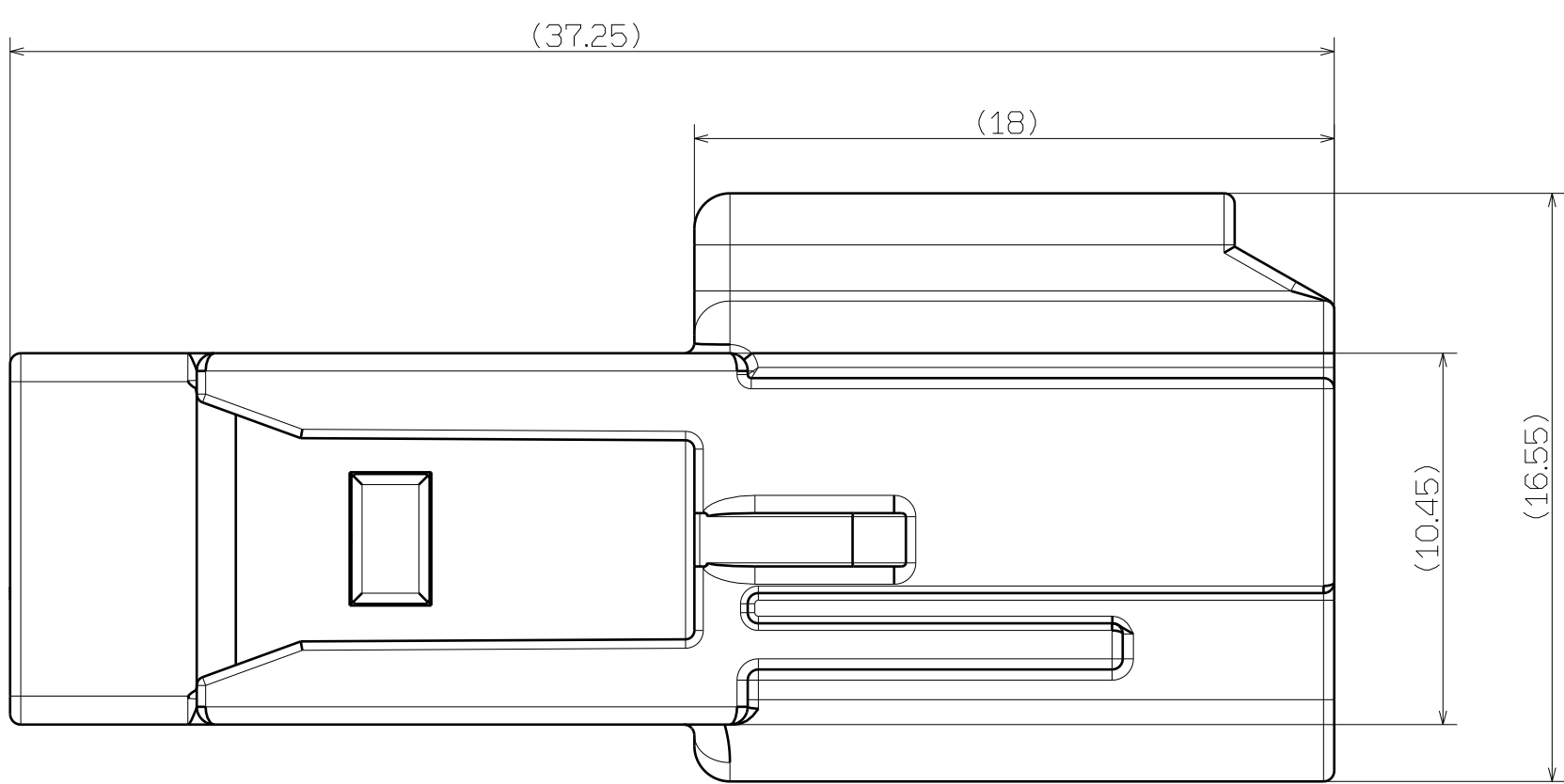

CAVITY IDENTIFICATION

- NOTE:
- PARTS CONFORM TO THE ELECTRICAL CONNECTION SYSTEM DESIGN SPECIFICATION (SDS) VER. 28
 - PARTS CONFORM TO GMW3191(2012)
 - FOR PERFORMANCE CRITERIA AND EXCEPTIONS, SEE SUMITOMO DVP&R
 - MAXIMUM MATING FORCE FULLY POPULATED WITH TIN TERMINALS IS 23.6 N
 - TERMINAL EXTRACTION TOOL: SUMITOMO PART NUMBER 23630005
 - N/A
 - CONNECTOR IS RATED AS ERGONOMIC CLASS 2 BASED ON USCAR-25 REV 1. CONNECTOR PUSH AREA IS APPROXIMATELY 220mm²
 - CONNECTOR INCLUDES A 7mm CLIP SLOT PER USCAR EWCAP-005-7
 - PART RECEIVED AT THE FORD PLANT OR SERVICE PART PACKAGER/WAREHOUSE MUST BE FREE OF ANY CORROSION ALIGNED WITH THE FORD CUSTOMER SERVICE DIVISION (FCSD) PACKAGING AND SHIPPING GUIDE. PACKAGING AND PROTECTIVE MATERIALS MUST PRESERVE THE INTENDED FUNCTION AND APPEARANCE OF THE PART.
 - CHANGES TO DESIGN, COMPOSITION OR PROCESSING OF THE PART PREVIOUSLY APPROVED FOR PRODUCTION REQUIRE PRIOR APPROVAL FROM FORD MOTOR COMPANY PRODUCT ENGINEERING. REFER TO ISO/TS 16949.
 - FOR CURRENT RELEASE STATUS, SEE THE WERS ENGINEERING NOTICE
 - THIS DRAWING HAS BEEN PREPARED BY OR ON BEHALF OF FORD MOTOR COMPANY. FORD MOTOR COMPANY RETAINS ALL COMMON LAW, STATUTORY AND OTHER RESERVED RIGHTS, INCLUDING COPYRIGHTS. THIS DRAWING MUST NOT BE USED FOR ANY PURPOSE OTHER THAN PERFORMING SERVICES DIRECTLY OR INDIRECTLY TO FORD MOTOR COMPANY. WITHOUT THE EXPRESSED WRITTEN PERMISSION OF FORD MOTOR COMPANY, UNAUTHORIZED USE, COPYING OR MODIFICATION, INCLUDING THE REMOVAL OF THIS NOTE, MAY CONSTITUTE A VIOLATION OF CIVIL OR CRIMINAL LAWS ENFORCEABLE BY FORD OR GOVERNMENTAL AGENCIES. COPYRIGHT 2020 FORD MOTOR COMPANY
 - FOR THE PURPOSES OF GEOMETRIC TOLERANCING, ALL DIMENSIONAL INFORMATION CONTAINED IN THE CAD MODEL IS BASIC (THEORETICAL)



SUMITOMO ELECTRIC WIRING SYSTEMS, LTD
248-482-1300
27360 DRAKE RD, FARMINGTON HILLS, MI 48331

ENG APP	APP DATE
GSDB CODE	SUPPLIER PART NUMBER
SEE CHART	

REFERENCE 120 6-WAY UNSEALED MALE CONNECTOR			
PART MUST COMPLY WITH RESTRICTED SUBSTANCE MANAGEMENT STANDARD WSS-M99P9999-A1 TO SAFEGUARD HEALTH, SAFETY AND THE ENVIRONMENT			
DRAFTED IN ACCORDANCE WITH FORD MOTOR COMPANY ENGINEERING CAD AND DRAFTING STANDARDS VERSION 30			3RD ANGLE PROJ DIMENSIONS ARE IN MILLIMETERS

CAD TYPE	CAD LOC.	CAD FILE	PRT MUST-14A459-TA	DTMC
K-CATIAS	TC	/1	DWG MUST-14A459-TA	IS MASTER
OPER. NO.	UNIT	DRAWING MU5T-14A459-TA		
N/A	N/A			
DESIGN	DETAIL	TITLE		SHT 1 OF 1
-	MW	SLV WIR CONN MALE		N/A
CHECKED	SAFETY			
-	MFG USE			
SCALE	DATE	DIVISION	N/A	
5 : 1		PLANT	N/A	



FORD MOTOR COMPANY

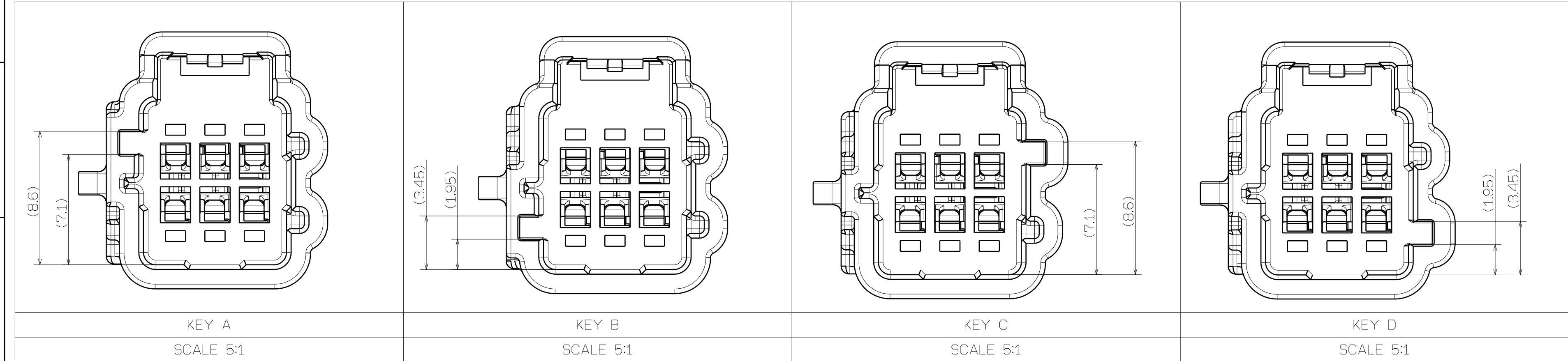

GENERAL TOLERANCES		
OVER	LESS THAN	
10	±0.2	
50	±0.3	

UNIQUE	SLV WIR CONN MALE	MUST-14A459-UA
DESCRIPTION	PART NAME	PART NUMBER